



**Culture, Community and Architecture Workshop:
'The Architecture of Community'**

Southampton Law School
University of Southampton
06 September, 2012

Future Sustainability of Housing Urban Low-Income People

The Success and Challenge
of **Walk-up Flat Delivery** in Yogyakarta, Indonesia

Deva Fosterharoldas SWASTO

Indonesia and Yogyakarta



Walk-up flat

- Low-rise vertical building, up to 4-6 storeys
- 1 block consist 100 unit
- No lift, just stairs
- Renting system (3 years each, maximum tenancy 2 periods)



General situation of walk-up flat

- Mass delivery since 2004
- Built in many big cities in Indonesia, included Yogyakarta
- Total 200 blocks for 20,000 units / families
- Part of upgrading / renewal program
 - Enhance environment
 - Minimise density
 - Equip with proper sanitation
- Alternative solution to house urban low-income people

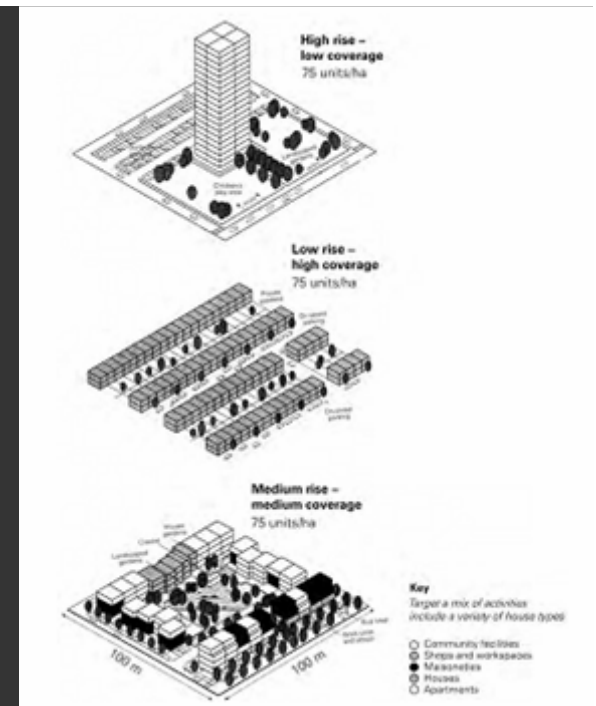

Problem

- Big subsidy for maintenance
- 1/4 or 53 cannot be occupied yet
 - Infrastructure not ready
 - No legal handed over (→ no financial support)
- Subletting
- Temporary renting
- People adaptation from horisontal to vertical

Is it worthy to continued?

(due to sustainability issue)

→ Evaluation in Yogyakarta



Physical aspect

- Unit size 21-27 m²
- 1 room, 1 kitchen, 1 bathroom, 1 balcony
- Physical adjustment
- Equipped with standard infrastructure
- Strategic location
- Limited space
- Sometimes imperfect building completion

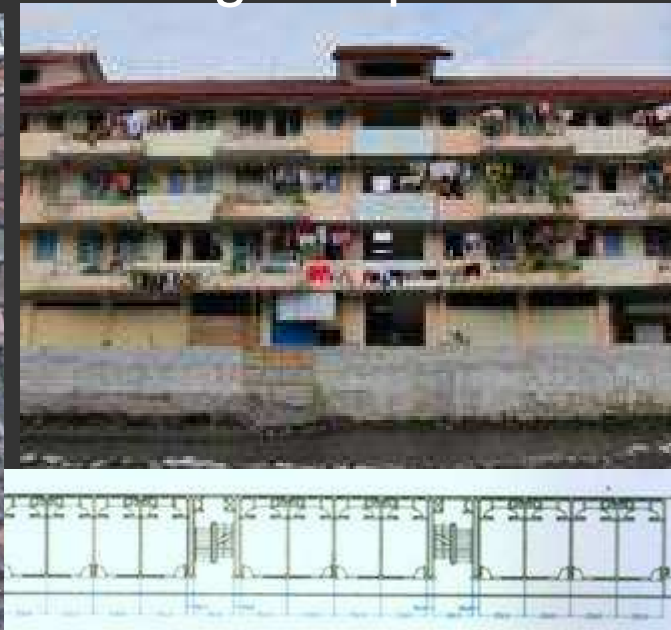
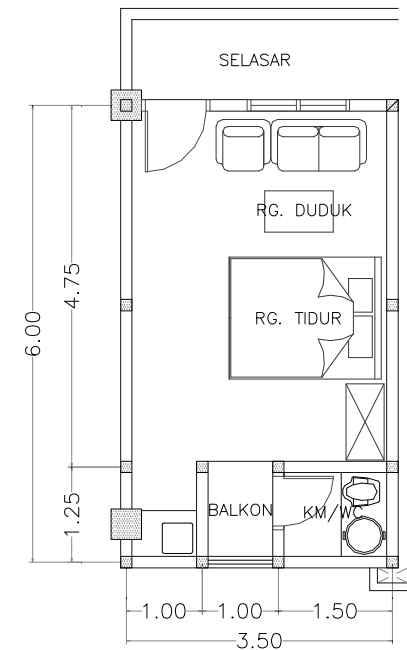

Managerial aspect

- Local people/leader as the manager
- New consensus of living vertically
- Community association
- Regular meeting



Social aspect

- Dweller's various background
- New social norms / value
- New habits and activity
- Behavioural adaptation

Source: Wulansari, Maulina, 2006



Notes

- Not all residents are low-income people
- Residents give positive evaluation
- Surrounding community give neutral opinion
- Impact to social dynamics and economics aspect
- Communal tolerance and mutual interaction as the main value above individual concern
- Short to medium-term tenancy
→ no further housing alternatives



Conclusion

- Walk-up flat as temporary situation / solution
- Enhancement of physical environment rather than sanitation awareness
- Local value (urban kampong spirit) as binder of social harmony → determine its success
- From informal → formal
- From top down regulation → social controlled norm
- If the delivery is expected to be continued, it is suggested to have some improvements
 - Physical: more perfected completion
 - Specific target: young family, job characteristic
 - The need of further housing alternatives
 - Measured impact



Thank you

Deva Fosterharoldas SWASTO
d.f.swasto@ncl.ac.uk, devafswasto@yahoo.com

Ph.D student at School of Architecture,
Planning and Landscape
University of Newcastle upon Tyne, UK

Lecturer and Researcher
Department of Architecture and Planning
Faculty of Engineering, Gadjah Mada University,
Yogyakarta, Indonesia